

D-29-51

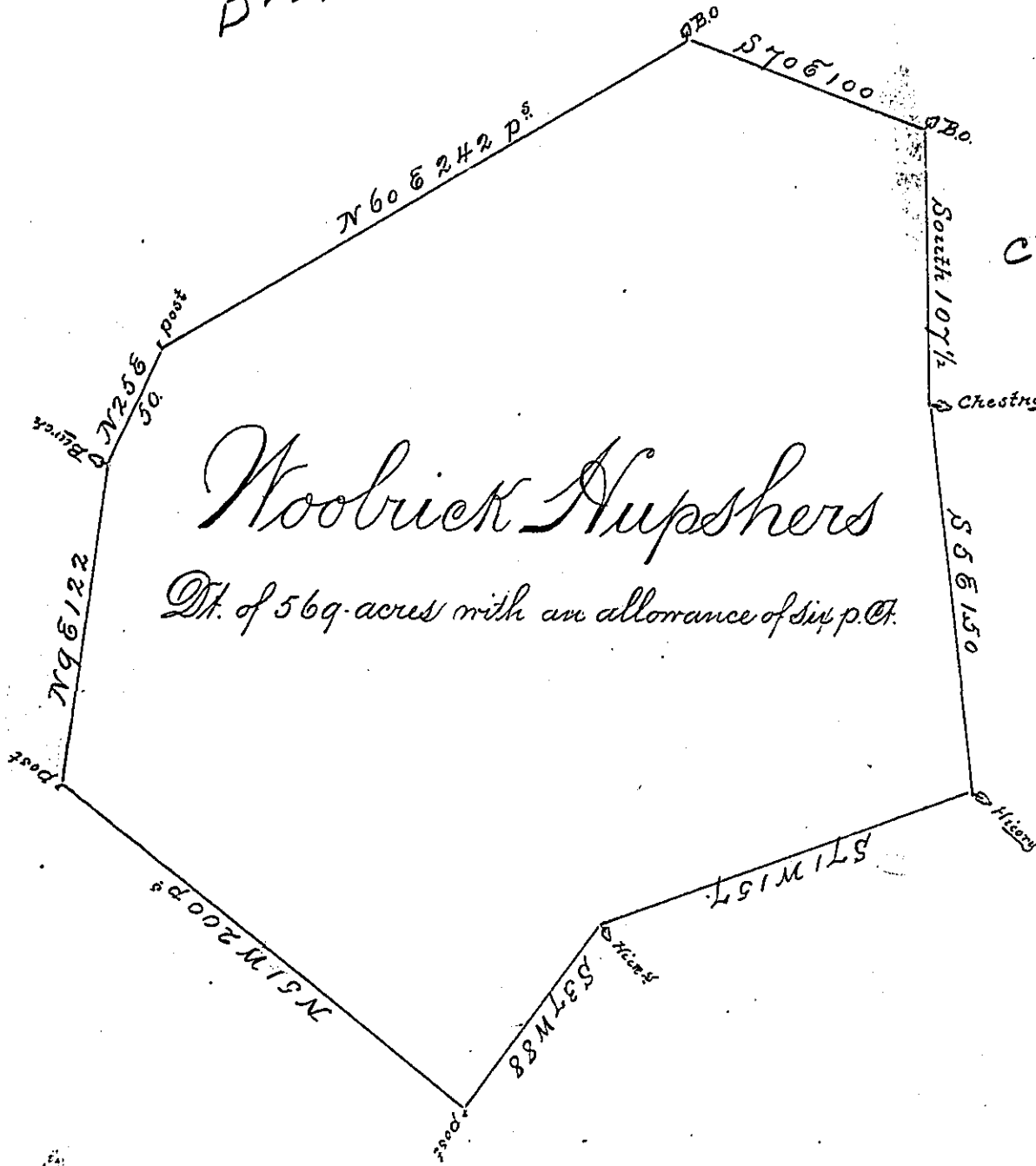

Woolrick Nupshers

Tr. of 569 acres with an allowance of six p.Ct.

C-90-64

B-5-114

A Draught of Woolrick Nupshers Land Situate
 In Derry Township and County of Lancaster
 Containing 569. acres With an allowance of Six p.Ct.
 For Roads and Highways By Virtue of the Honourable
 the proprietaries Warrant Deated the 26th Day of October
 1750 and Surveyed the 10th Day of March 1754.

p me

Wm Galbreath Des.

To Nicholas Scull, Esq^r }
 Surveyor General }

IN TESTIMONY that the above is a copy of the original remaining on file in
 the Department of Internal Affairs of Pennsylvania, made
 conformably to an Act of Assembly approved the 16th day of
 February, 1833, I have hereunto set my Hand and caused
 the Seal of said Department to be affixed at Harrisburg,
 this fourth day of April 1899.

James W. Fitter
 Secretary of Internal Affairs.